

Thank you for purchasing one or more Nautilus overhead service carrier units.

Various models of Nautilus units are available and vary in length, width, height and options. When ordering replacement parts, have a complete description and model number of your unit(s).

Before starting assembly, have the proper tools and required materials available, and wear appropriate safety equipment when using tools.

Tools required: (Not Included)

Tape measure
Screwdrivers - #1 and #2 Phillips
Electric Drill
Set of Drill Bits
Wrenches - Open or Box
Socket Wrench Set

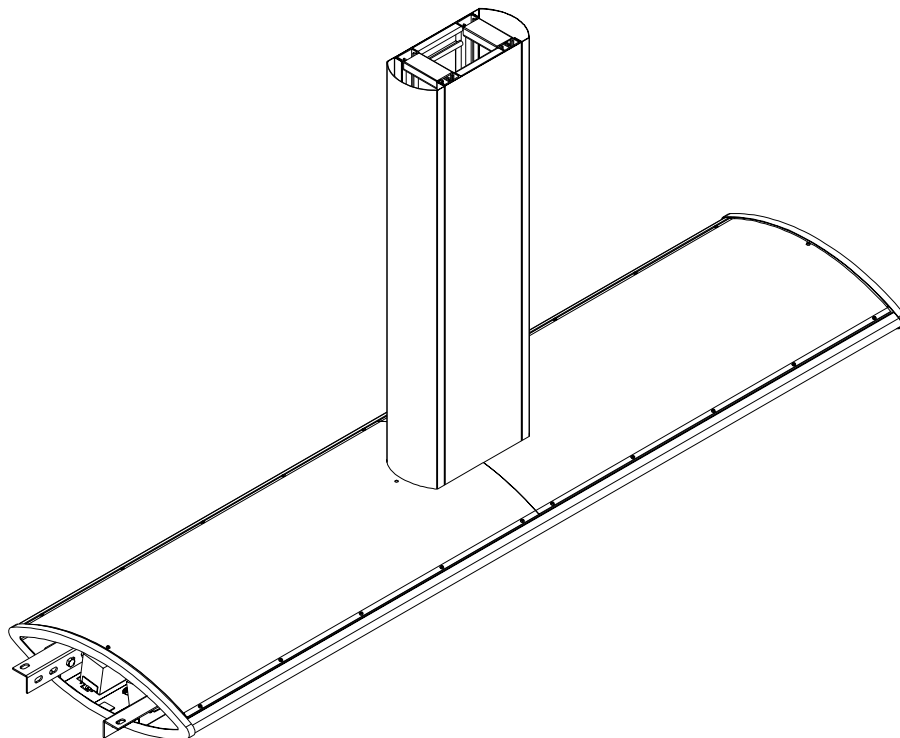

I. Assemblies

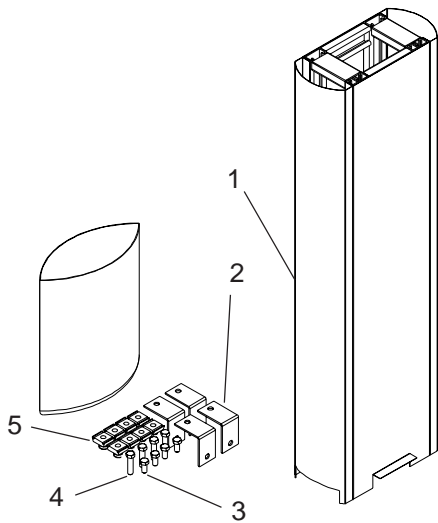

Carrier Assembly

Contains: 1 - Carrier Assembly

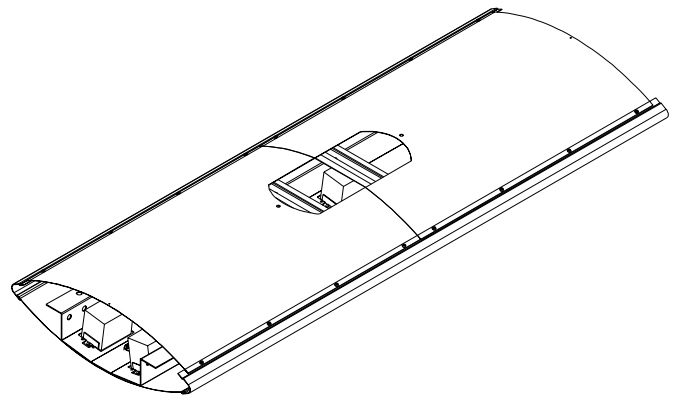

Umbilical Package

Contains:

Item	Qty	Description
1	1	Umbilical Assembly
2	4	Mounting Clips
3	4	3/8-16 x .75 Hex Cap Screws
4	4	3/8-16 x 1.50 Hex Cap Screws
5	8	3/8-16 Spring Nuts

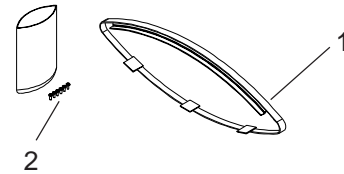
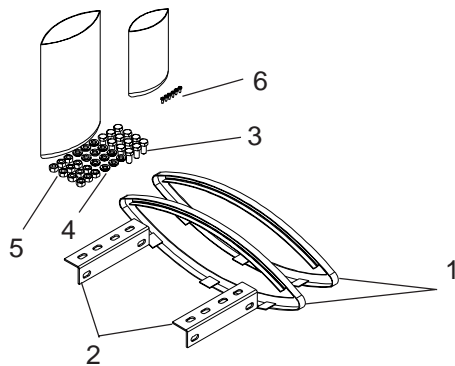

End Cap Assembly

Contains:

Item	Qty	Description
1	1	Solid End Cap
2	6	#6 x 3/8 Phillips Self Drilling Screws

Splice Cap Assembly

Contains:

Item	Qty	Description
1	2	Splice Caps
2	2	Splice Angles
3	12	3/8-16 x .75 Hex Cap Screws
4	12	3/8 Lockwashers
5	12	3/8 Hex Nuts
6	6	#6 x 3/8 Phillips Self Drilling Screws

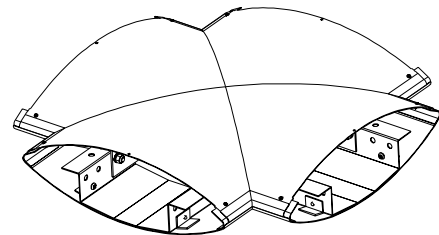

Intersection Assembly

Contains: 1 - Intersection Assembly

II. Fastening Umbilical to Carrier

1. Remove item #1 and item #2 panels from item #3 Umbilical Frame.
 - a. Panels are fastened by a keyhole slot. Remove item #1 End Panel by raising up and pulling outward (see Fig. 2).
 - b. Remove item #2 Side Panels. Pull upward on panel, then lift flanges away from screws.

2. To replace covers reverse above order.

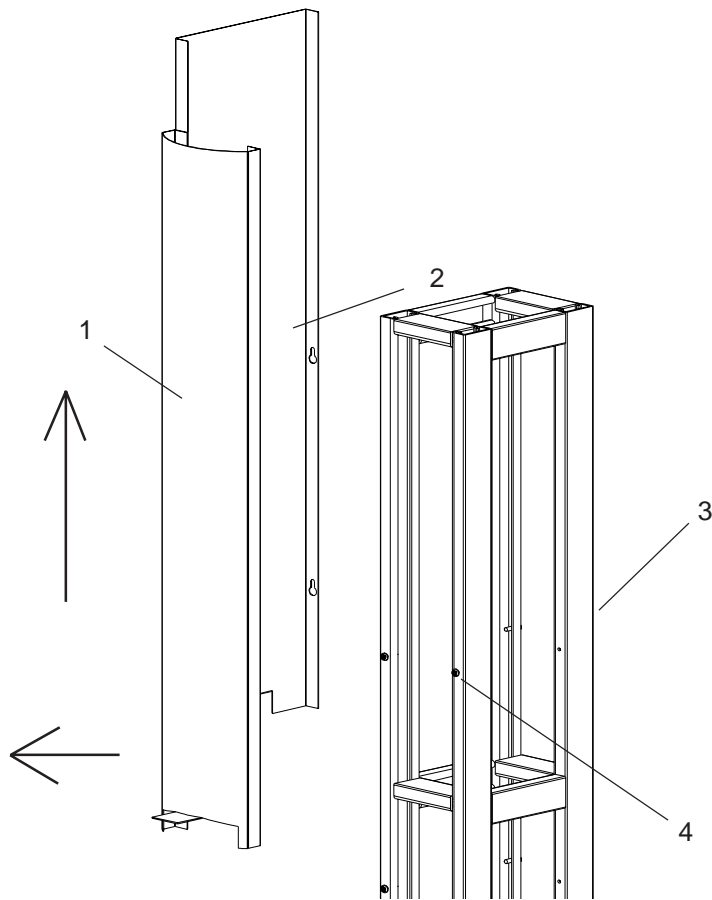

Fig. 2

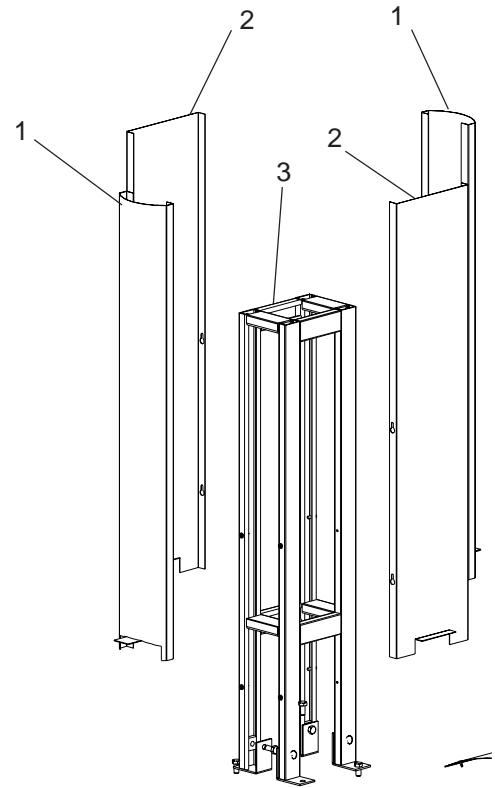

Fig. 1

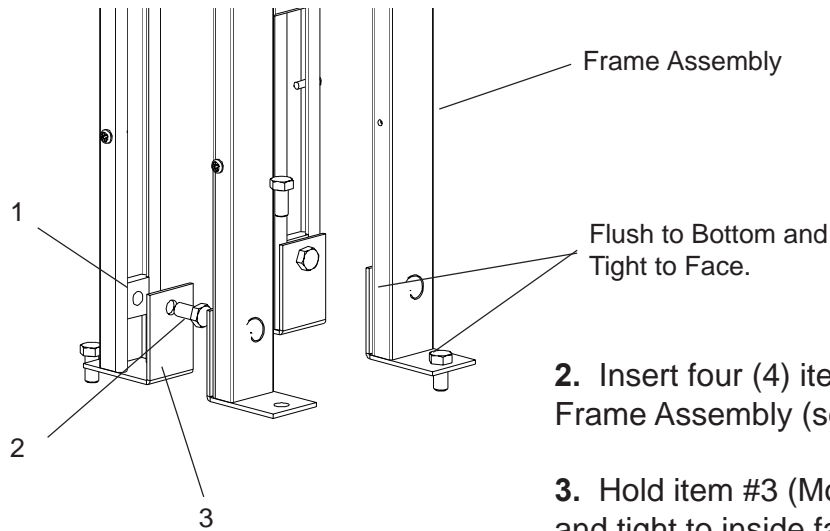

Fig. 3

2. Insert four (4) item #1 (3/8 Spring Nut) into Frame Assembly (see Fig. 3).

3. Hold item #3 (Mounting Clip) flush to bottom and tight to inside face of Frame Assembly (see Fig. 3).

4. Insert and hand tighten item #2 (3/8-16 x .75 Hex Cap Screws).

5. Repeat for remaining legs.

6. Remove top panels from Carrier Assembly by removing screws and lifting (see Fig. 4).

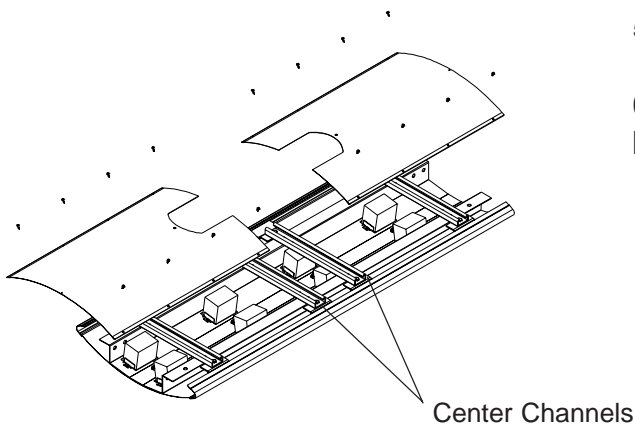

Fig. 4

7. Insert four (4) item #1 (3/8 Spring Nut, see Fig. 5) into center channels of Frame Assembly (see Fig. 4)

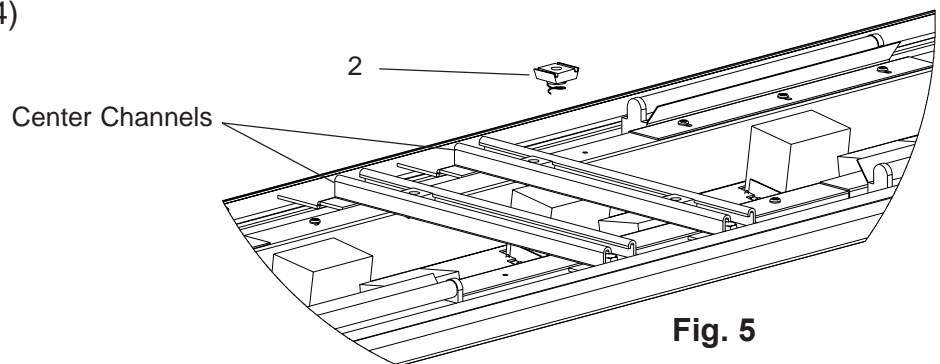
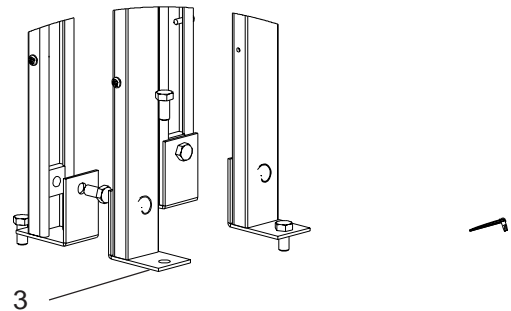

Fig. 5

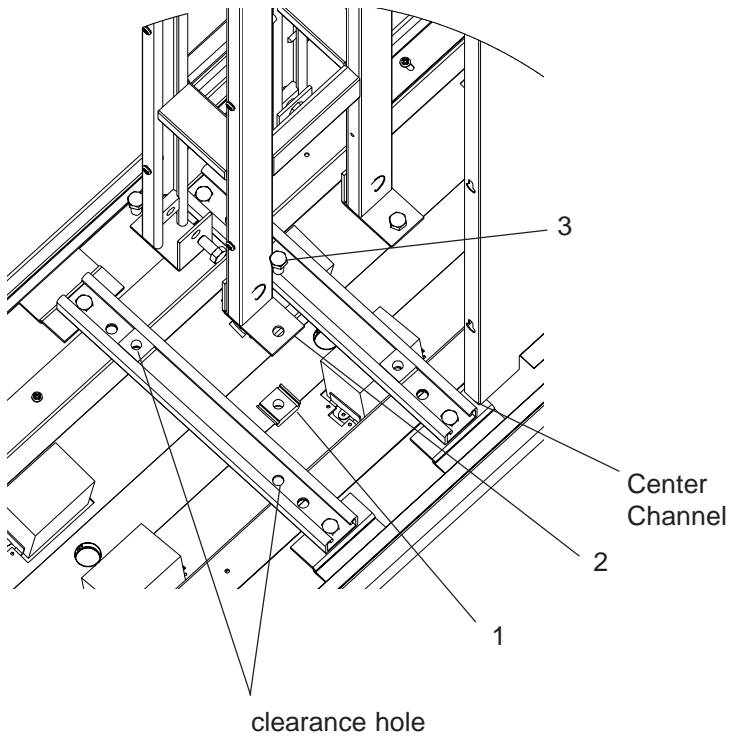

Fig. 6

8. Align item #1 (3/8 Spring Nut) and item #2 (Mounting Angle) with the clearance hole on the center channel (see Fig.6). Insert and fasten item #3 (3/8-16 x 1.50 Hex Cap Screw) to item #1 (3/8 Spring Nut) and clearance hole in Center Channel. **Do not tighten.**

9. Repeat for remaining corners.

10. Tighten all screws.

11. Replace Umbilical Covers (see 1.)

III. Installing End Caps

1. Position item #1 (End Cap) with flange on outside of Carrier Assembly and tabs on inside as shown (see Fig. 7).

2. Push the item #1 (End Cap) firmly against Carrier Assembly.

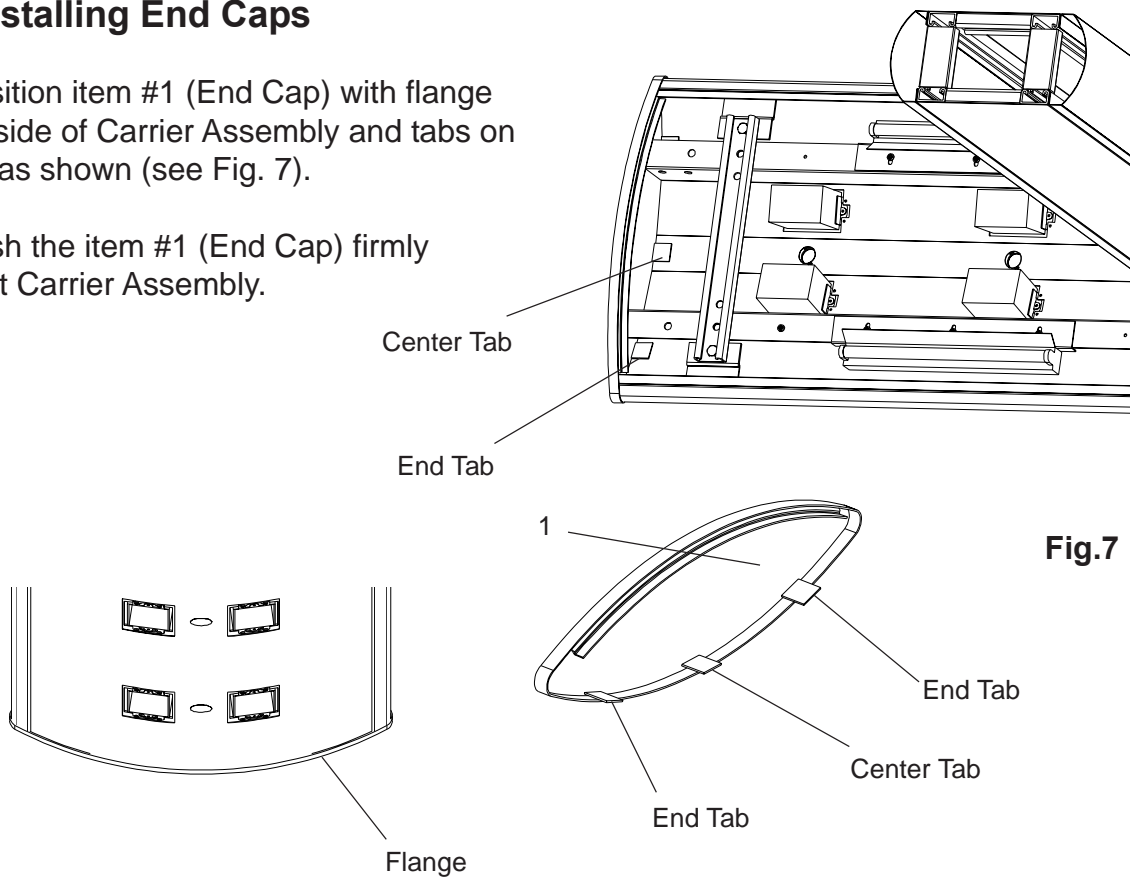
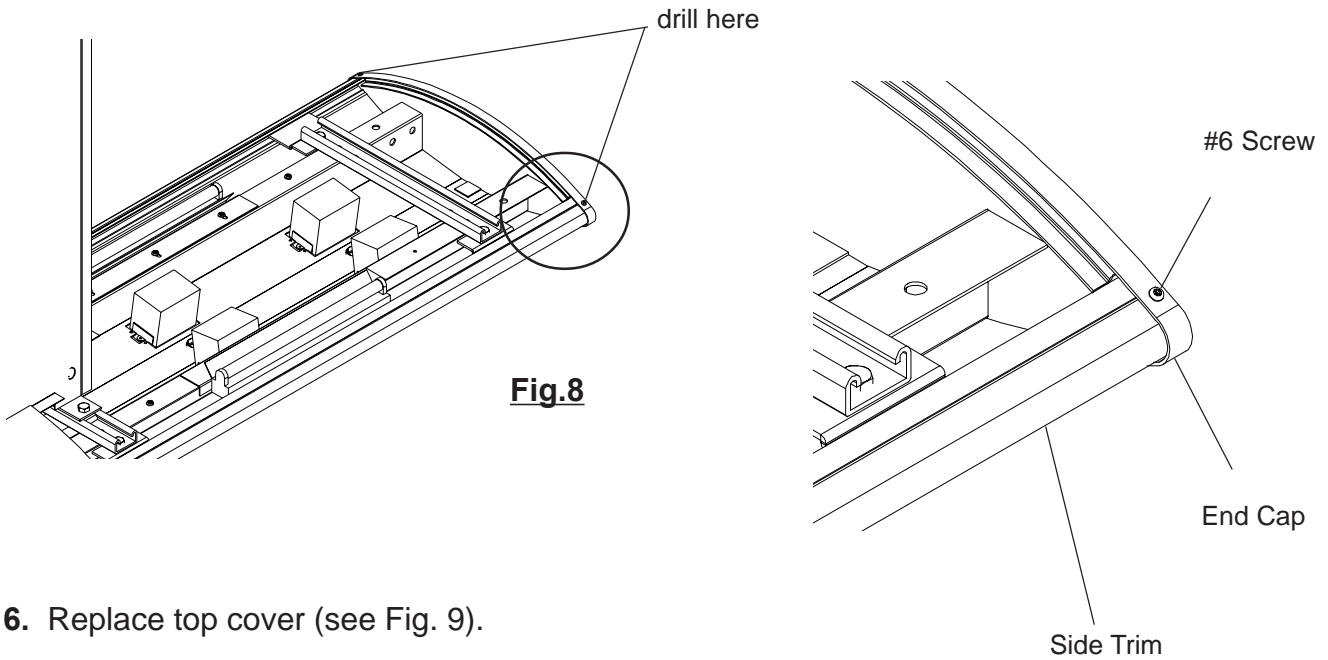
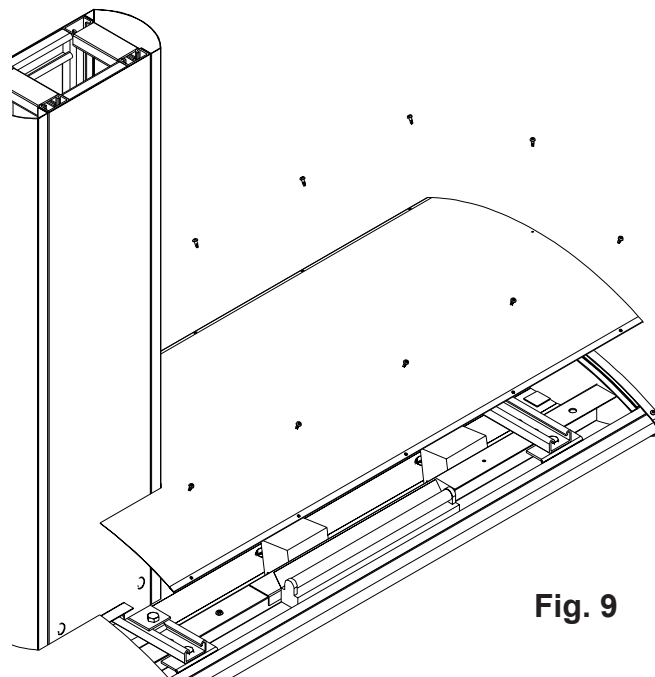

Fig.7

3. While holding End Cap firmly on Carrier Assembly, drill a 7/64" dia. hole through End Cap and Side Trim. (see Fig. 8).
4. Insert the #6 self drilling screw supplied.
5. Repeat for other side.



6. Replace top cover (see Fig. 9).
7. Fasten cover in place.



IV. Installing Splice Angles

The Splice Angles are used to connect two carriers to each other or to the inter-section assembly.

1. Position item #1 (Splice Angle) over holes in Carrier Assembly (see Fig. 10).
2. Insert item #2 (3/8-16 x .75 Hex Cap Screw) through holes.
3. Hand fasten in place using item #3 (3/8 Lockwasher) and item #4 (3/8 Hex Nut).
4. Repeat for remaining Splice Angle.
5. Tighten all fasteners.
6. Install Splice Cap (see **Section III. Installing End Caps**).
7. Replacetop cover (see Fig. 11).
8. Fasten Top Cover in place.

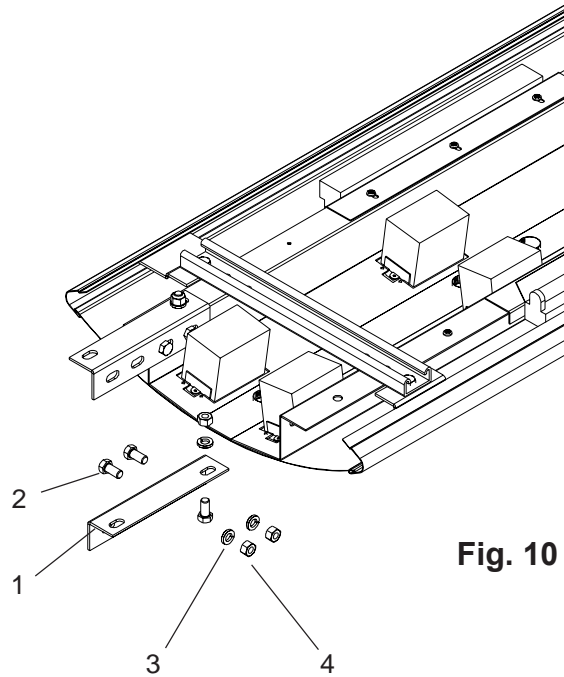

Fig. 10

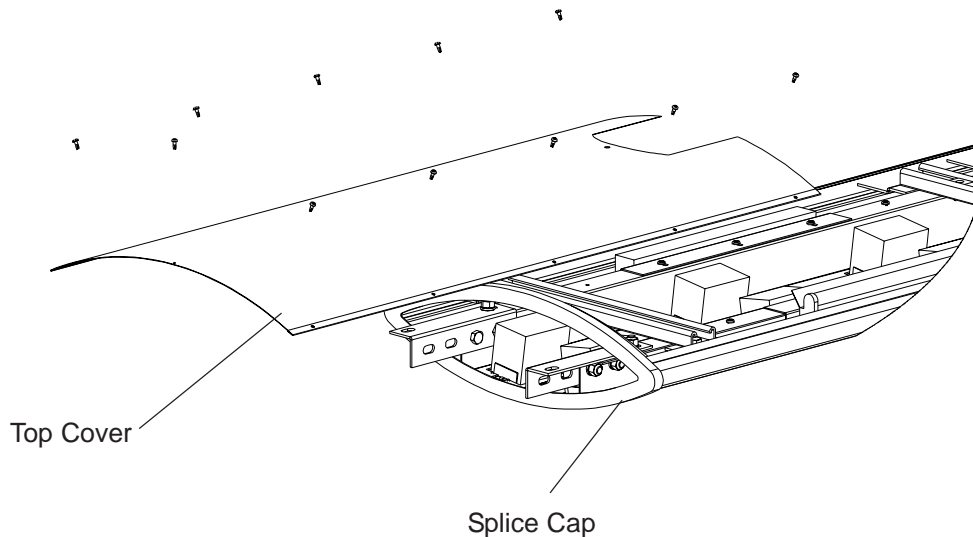

Fig. 11

V. Installing Intersection Assembly

1. Remove Top Cover from Intersection Assembly by removing screws and lifting.
2. Install End Caps on the Intersection Assembly (see **Section III. Installing End Caps**). Do not replace Top Cover at this point.
3. Align Carrier Assembly with Intersection Assembly.
4. Pull and hold units tightly together.
5. Insert item #1 (3/8-16 x .75 Hex Cap Screw) into appropriate holes.
6. Fasten in position with item #2 (3/8 Lockwasher) and item #3 (3/8 Hex Nut).
7. While holding units firmly together, tighten all fasteners.
8. Repeat for all intersections required.
9. Replace Top Cover on Intersection Assembly. **Do not overtighten screws.**

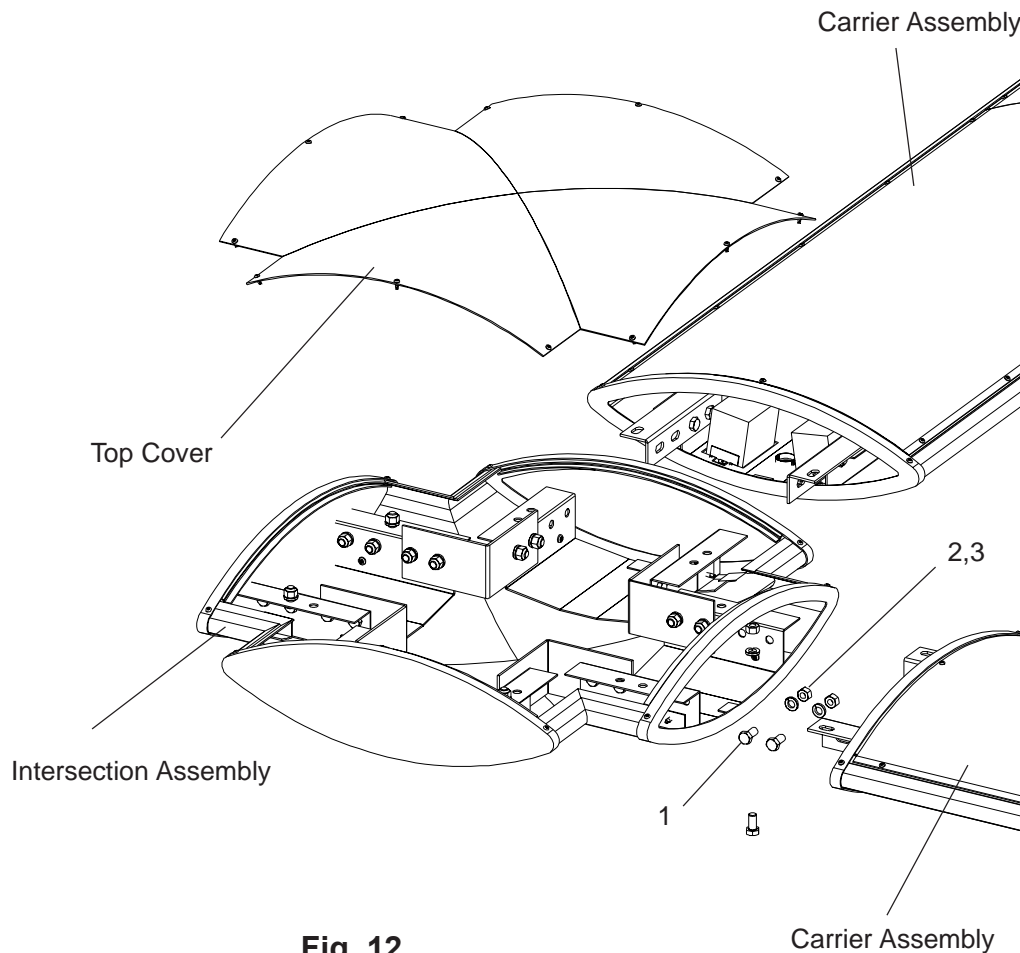

Fig. 12

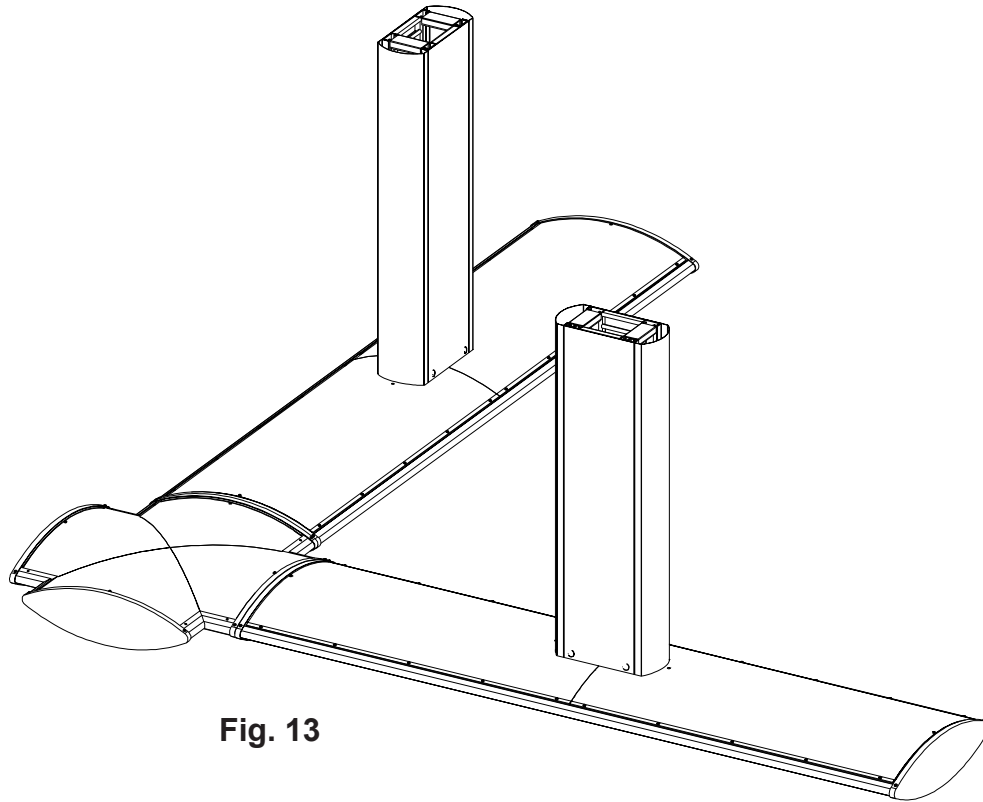

Fig. 13

Finished Assembly

VI. Trimming Umbilical

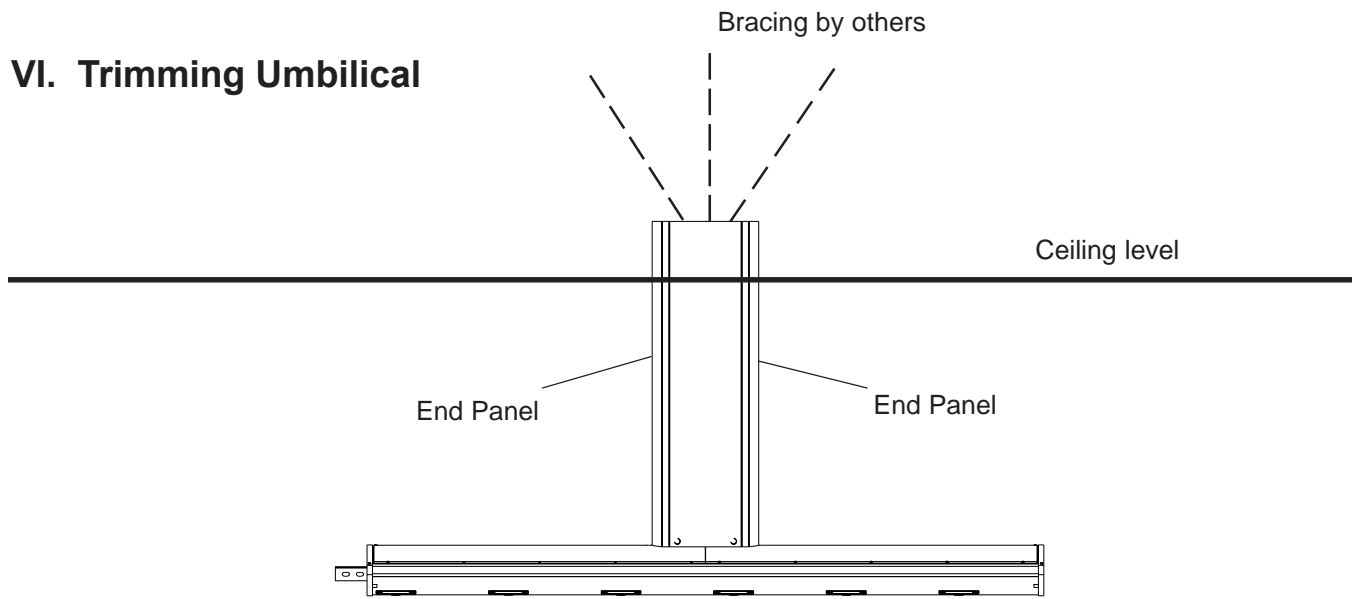

Fig. 14

If access to the inside of the umbilical after installation is necessary, follow the instructions below.

1. Place a mark on End Panels at ceiling penetration point.
2. Remove Top Covers from Carrier Assembly (see Fig.4).
3. Remove Side Panels (see **Section II. Fastening Umbilical to Carrier**).
4. Trim End Panels so that they protrude approximately 1/2" above ceiling level.

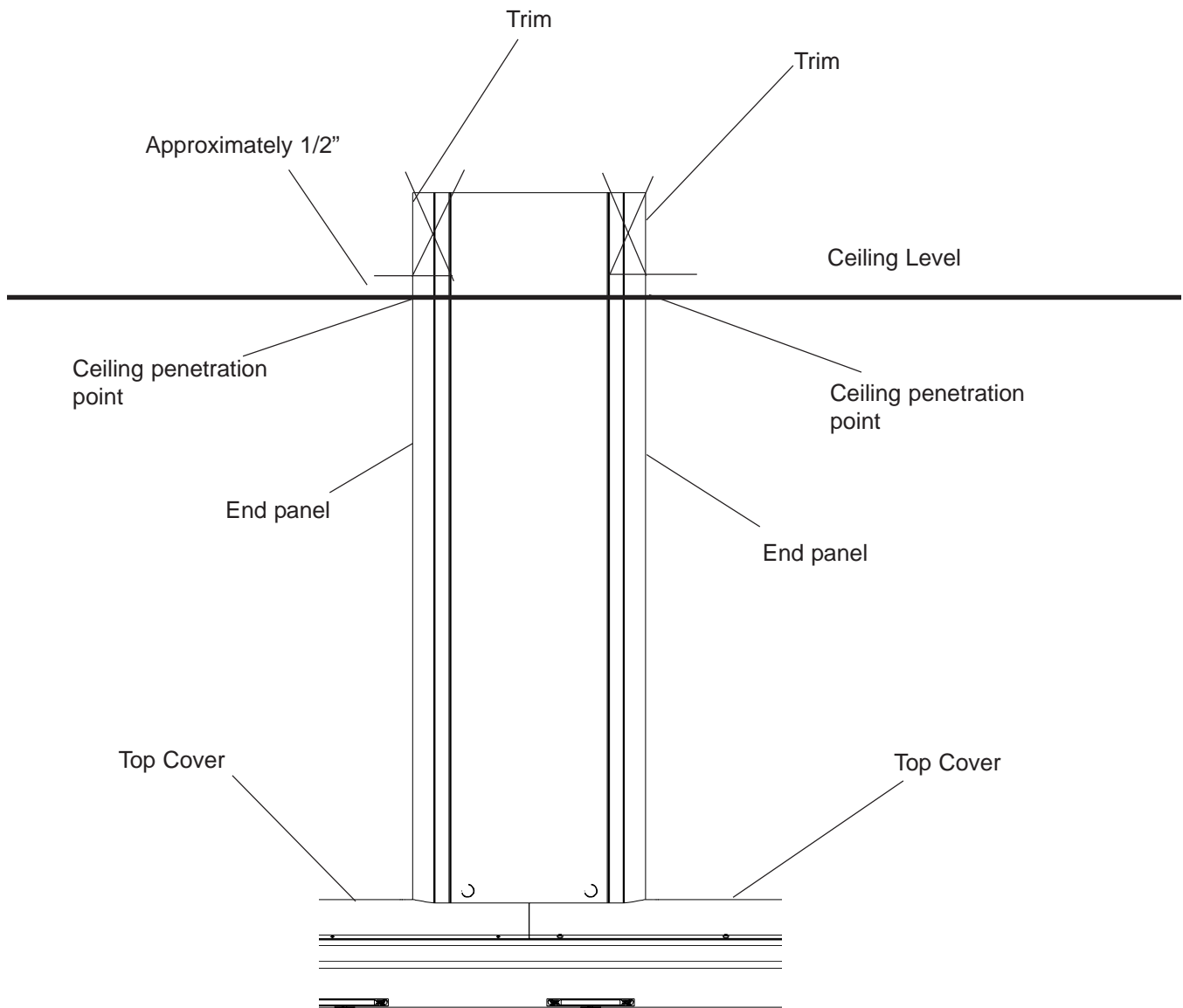

Fig. 16

To access the umbilical chase after installation, follow the instructions below.

1. Remove Top Panels from Carrier Assembly (see **Section II. Fastening Umbilical to Carrier**).
2. Push upward on End Panel for removal.
3. Pull End Panel off screws by moving the bottom of End Panel laterally.
4. To reattach End Panel, reverse above steps.

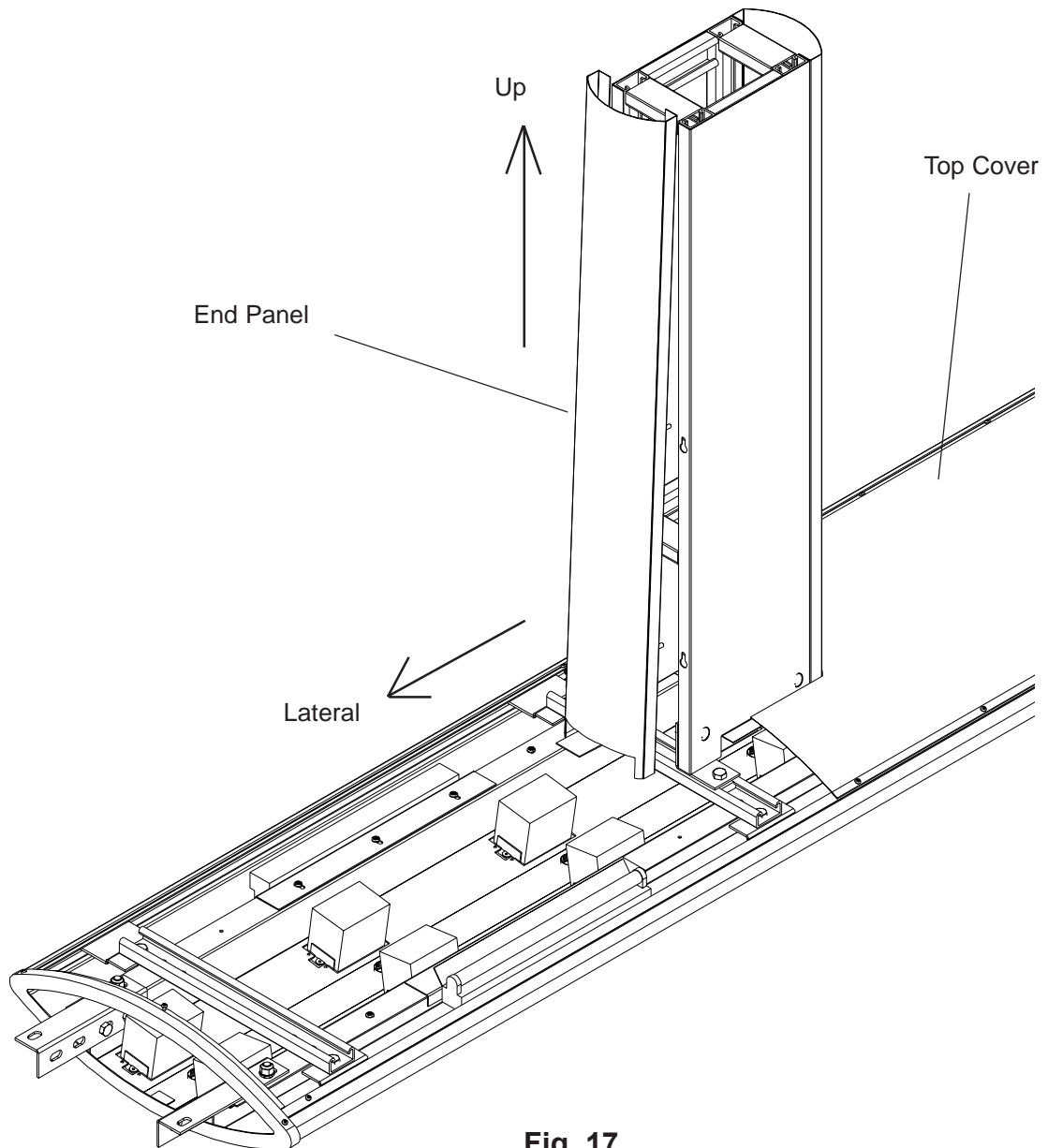

Fig. 17